

North Lebanon Township

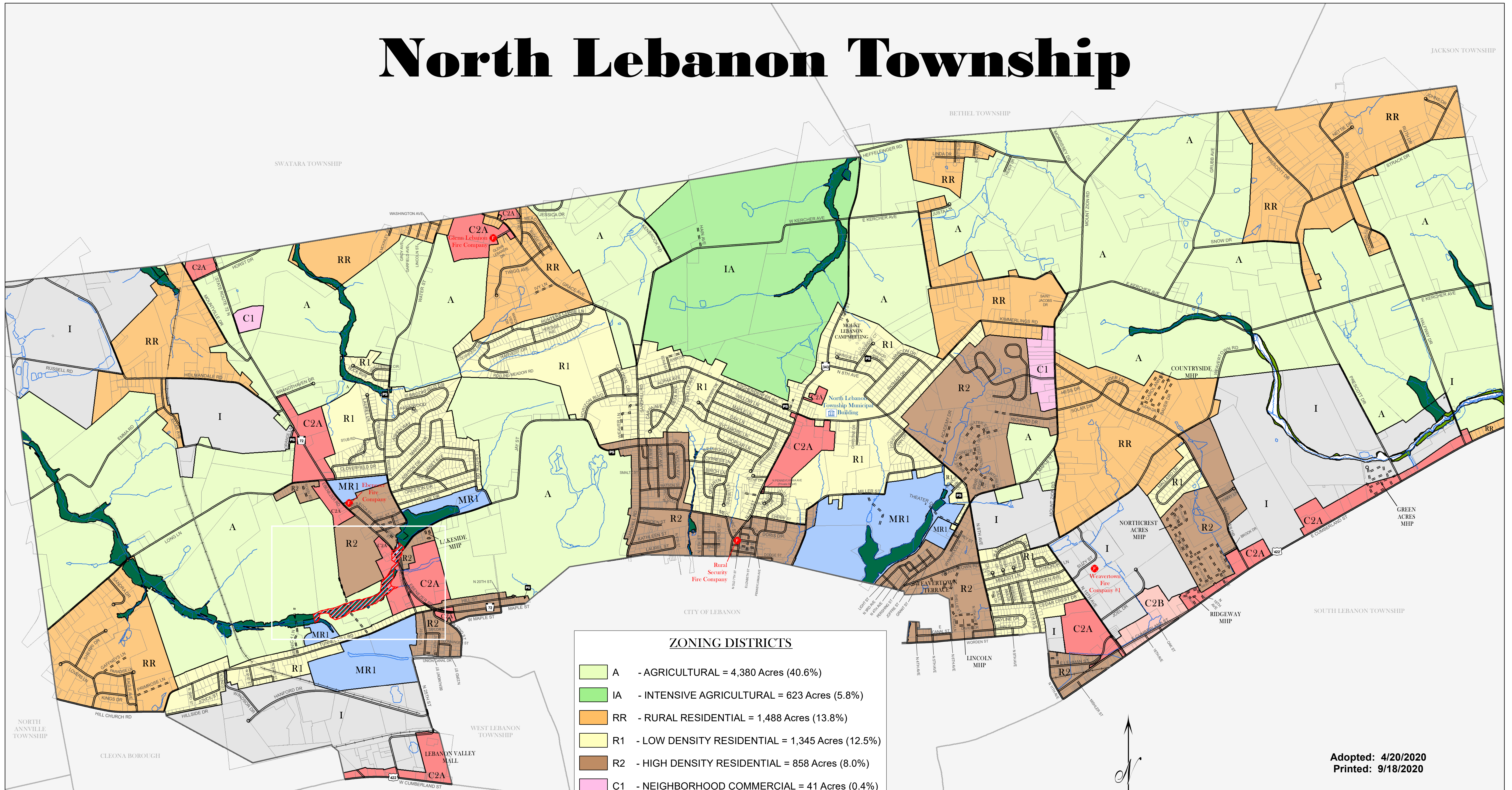

ZONING DISTRICTS

	A - AGRICULTURAL = 4,380 Acres (40.6%)
	IA - INTENSIVE AGRICULTURAL = 623 Acres (5.8%)
	RR - RURAL RESIDENTIAL = 1,488 Acres (13.8%)
	R1 - LOW DENSITY RESIDENTIAL = 1,345 Acres (12.5%)
	R2 - HIGH DENSITY RESIDENTIAL = 858 Acres (8.0%)
	C1 - NEIGHBORHOOD COMMERCIAL = 41 Acres (0.4%)
	C2A - GENERAL COMMERCIAL = 347 Acres (3.2%)
	C2B - GENERAL COMMERCIAL = 36 Acres (0.3%)
	MR1 - MUNICIPAL RECREATION = 333 Acres (3.1%)
	I - INDUSTRIAL = 1,331 Acres (12.3%)

SPECIAL FLOOD HAZARD AREA*

	ZONE A
	ZONE AE - FLOODWAY
	ZONE AE
	DAM BREACH INUNDATION AREA

*CONSULT F.E.M.A. MAPS FOR EXACT LOCATIONS

TOWNSHIP TOTAL ACREAGE = 10, 735 Acres

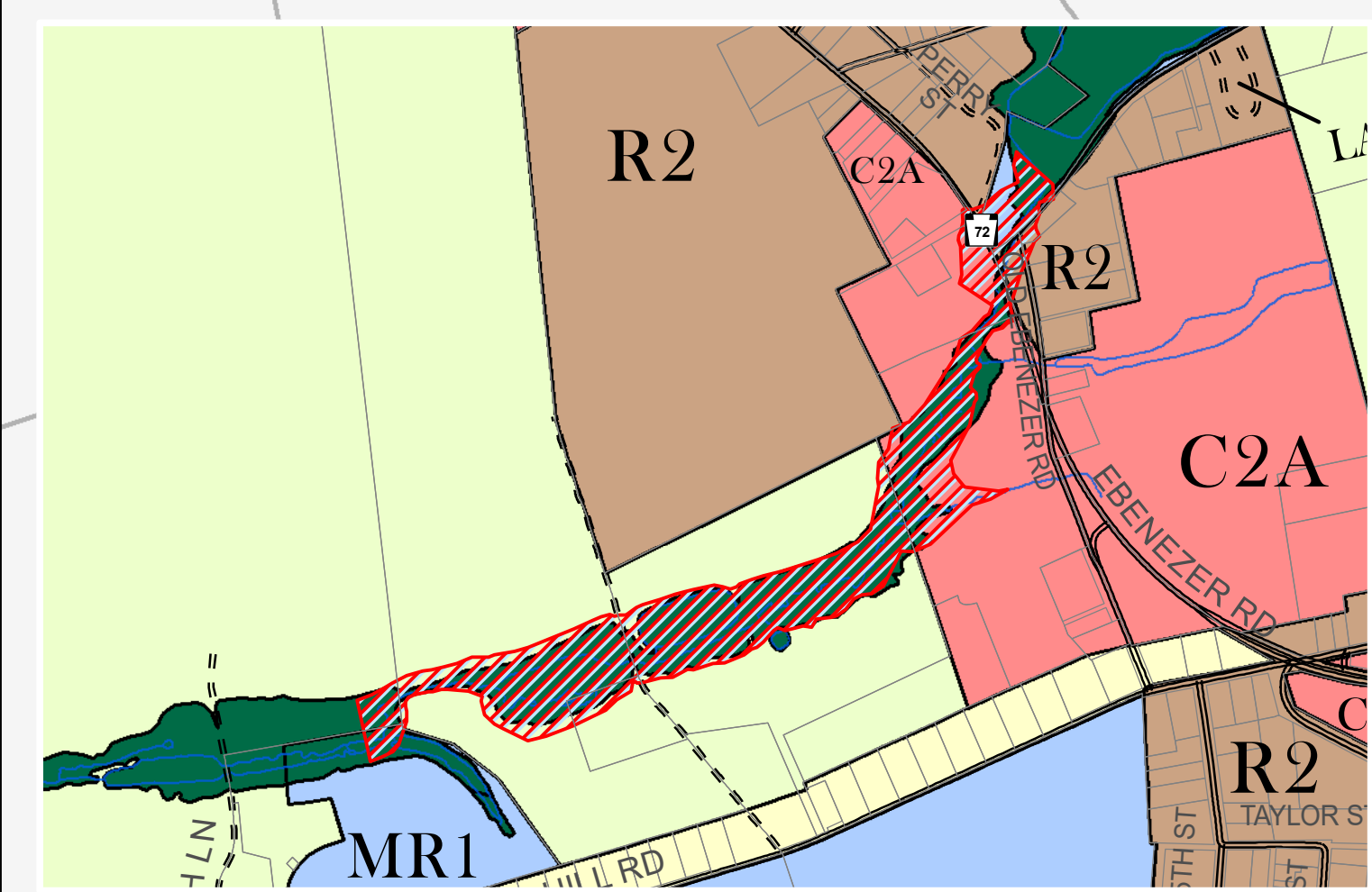

Legend

	Pump Stations
	Parcels
	Railroad Beds
	Hydrology
	Roads
	Private Roads

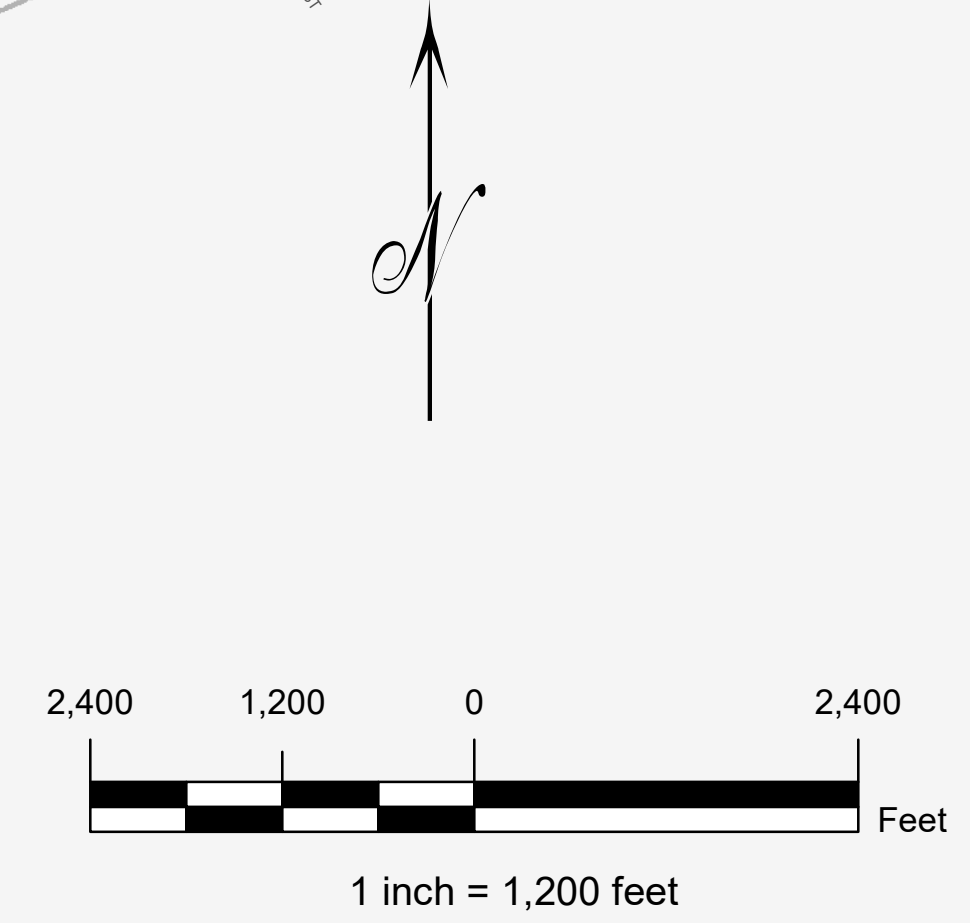

Map Prepared by the Lebanon City Authority/County GIS Department

Disclaimer:
Tax maps show the approximate boundaries of taxable and non-taxable property. The property boundaries depicted should not be interpreted as the legal boundary description. The legal boundary description can be obtained from the property's deed.

NOTE:
ZONING DISTRICT BOUNDARIES INDICATED AS APPROXIMATELY FOLLOWING THE CENTERLINE OF ROADS OR BODIES OF WATER SHALL BE CONSTRUED AS FOLLOWING SUCH CENTERLINES. SHOULD ANY UNCERTAINTY EXIST, THE ZONING HEARING BOARD SHALL INTERPRET THE INTENT OF THE ZONING MAP AS TO THE EXACT LOCATION OF DISTRICT BOUNDARIES.

NOTE: PROPERTY LINES DISPLAYED FOR REFERENCE PURPOSES ONLY

Adopted: 4/20/2020
Printed: 9/18/2020